

FAQ

WHERE DOES MY INFANT OR PRESCHOOLER GO?

A member of our welcome team will take you to the preschool wing on the main level for infants through age 4. Preschool children may stay in their class for all sessions while you attend worship and a Life Group. You will sign them in at the preschool welcome desk. You will provide your cell phone number so that you can be reached if your child needs you.

WHERE DOES MY ELEMENTARY AGE CHILD GO?

Kindergarten through third graders participate in classes for their grade level. They attend at 9:00 or 10:15 to match your schedule. Please pick them up from their classroom right after that session. At 10:15 or 11:30, Kindergarten through third graders may attend children's worship, called BOOM! (See children's worship information below.)

BOOM! CHILDREN'S WORSHIP

Our children's worship service called BOOM! is for Kindergarten through the third grade and meets in Room 107. Your child can attend BOOM! at either 10:15 or 11:30 and attend the Elementary Kids Life Group at 9:00 or 10:15. Parents will drop their children off at BOOM! and will also need to pick them up at the end of that service.

WHERE DOES MY PRETEEN GO?

Fourth and fifth graders go to Flyte, our pre-teen group, at 9:00 and 10:15. They meet in the gym and then go to room 303. Please discuss with your preteen a predetermined place to meet afterward.

WHERE DOES MY MIDDLE/HIGH SCHOOLER GO?

Sixth-twelfth graders gather in the Fellowship Hall at 10:15 for a time of teaching and discussion. They attend the main worship service during the 9:00 or 11:30 session. Please discuss with your teen a predetermined place to meet afterward.

STAFF

LEAD PASTOR

John Mark Harrison
johnmark@apexbaptist.org

WORSHIP PASTOR

Ryan Wingo
ryan@apexbaptist.org

SENIOR ADULTS PASTOR

Peter Dubbelman
peter@apexbaptist.org

PASTOR OF ADMINISTRATION

Tim Shaw
tim@apexbaptist.org

NEXT GEN MISSIONS PASTOR

Nathan Stam
nathan@apexbaptist.org

CONNECTIONS PASTOR FRIENDSHIP CAMPUS

Jason Rumbough
jason@apexbaptist.org

STUDENT PASTOR

Jace Thomas
jace@apexbaptist.org

SPIRITUAL DEVELOPMENT PASTOR

Matt Curry
matt@apexbaptist.org

ASSOCIATE WORSHIP PASTOR

Jamie Joyce
jamie@apexbaptist.org

MINISTRY ASSOCIATE

Tyler Womble
twomble@apexbaptist.org

MINISTRY ASSOCIATE

John Wyman
jwyman@apexbaptist.org

MINISTRY ASSOCIATE

Reese Miller
reese@apexbaptist.org

MINISTRY ASSOCIATE

Ciara Delgado
ciara@apexbaptist.org



LIFE GROUPS

110 SOUTH SALEM ST.
APEX, NC 27502
www.apexbaptist.org

PRESCHOOL

	9:00	10:15	11:30
Infants	231	231	222
Crawlers	229	229	229
Young One's	222	222	222
Older One's	224	224	222
Younger Two's	226	226	222
Older Two's	227	227	222
Young Three's	228	228	222
Older Three's	225	225	222
Four's	230	230	222

CHILDREN

	9:00	10:15	11:30
Kindergarten	307	307/Boom	Boom
1st Grade	308	307/Boom	Boom
2nd Grade	302	305/Boom	Boom
3rd Grade	305	305/Boom	Boom
Special Needs	232	232	

FLYTE

	9:00	10:15
4th Grade	Gym/303	303
5th Grade	Gym/303	303

STUDENT

	10:15
6th-12th Grade	Fellowship Hall

EN ESPAÑOL

	10:15	
Coed Adults	102	Jim Munger
Coed Adults	103	Segundo Bazan

ADULT LIFE GROUPS

9:00	ROOM	LEADER
Coed 20's & 30's	313	Winstead
Coed 20's & 30's	312	Hughes/Dennis
Coed 20's & 30's	233	Alexander/Epp
Coed 30's & 40's	103	Eng
Coed 30's & 40's	311	Yates/Maynard
Coed 40's & 50's	310	Shaw
Coed 50's +	315	White/Wiest
Coed 60's +	102	Lynch
Women All Ages	309	Merritt
Women 60's +	210	Mclver
Women 60's +	211	Dubbelman/Cooke
Women 70's +	209	Olive
Men 60's +	304	Jones
Men 60's +	212	Fincher

10:15	ROOM	LEADER
College & Young Adults	312	Wyman
Coed 30's & 40's	315	Comer/Hoke
Coed 40's & 50's	313	Van Osdell
Coed 40's & 50's	309	Parlier
Coed 40's & 50's	311	Sanchez
Coed 50's +	310	Kelly/Torrence
Coed 50's +	211	Miller
Coed 60's +	209	Mills/Martin
Coed 60's	202	Gilbert/Lincoln
Women All Ages	210	Carroll

	DAY/ROOM/TIME	LEADER
Coed 30's & 40's	Sun/315/5:00	Donaldson
Coed 40's & 50's	Tues/Home/6:30	Walpole

For more information about Life Groups
contact matt@apexbaptist.org

DOWNTOWN CAMPUS MAP

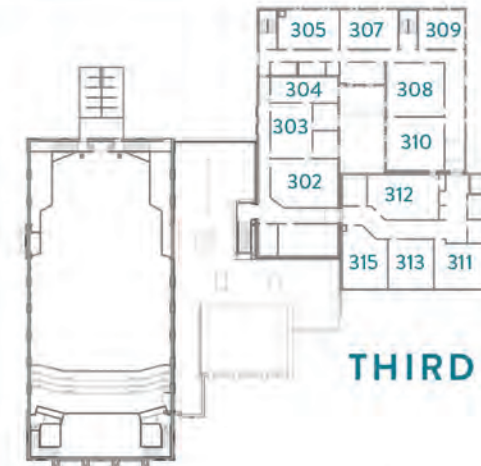

THIRD FLOOR



MAIN FLOOR



FIRST FLOOR